



Wireless On-Ear Headphones

User Manual | VWS-H90

Introduction

The head-mounted Bluetooth headphones utilize advanced audio technology to deliver an immersive sound quality experience. With deep bass, clear mids, and soaring highs, they offer a full-range, high-fidelity audio performance.

Specifications

Model: NBB
 Bluetooth Version: Bluetooth 6.0
 Material: ABS
 Battery Capacity: 400mAh/1.48Wh
 Input Power: 5V~300mA
 Charging Port: USB-C

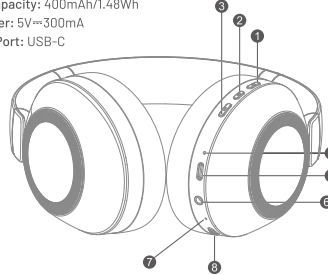

Product Overview

1 Volume +	5 USB-C Charging Port
2 Pause/Play	6 Audio Input Jack
3 Volume -	7 Microphone
4 Indicator Light	8 Power Toggle Switch

Instructions for Use

1. Power On

Slide the power switch upward.

2. Pairing & Connection

When powered on from an off state, the headphones will emit a prompt sound. After 2 seconds, the indicator light will flash red and blue alternately, entering automatic pairing mode. On your phone, select the device named "Vention ST1" from the Bluetooth list.

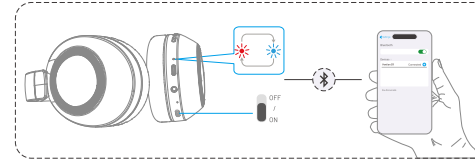

3. Power Off

• Manual: Slide the power switch downward.
 • Auto: Powers off automatically after 5 minutes of inactivity.
 Note: The headphones will automatically turn off when charging.

4. Wired Connection

When powered on, inserting a 3.5mm audio cable will disable Bluetooth and prioritize wired audio connection.

For more interesting information and events, please follow us on social media platforms:



Facebook



LinkedIn



Instagram

For warranty service or support, please contact Vention team:
 Website: www.ventiontech.com Email: vention@ventiontech.com

5. Music Play

Play	Short press the Play/Pause button.
Pause	Short press the Play/Pause button.
Next Track	Press and hold the "+" button for 2s.
Previous Track	Press and hold the "-" button for 2s.
Volume Up	Short press the "+" button.
Volume Down	Short press the "-" button.

6. Phone Calls

Redial	Double press the Play/Pause button.
Answer	Single press the Play/Pause button.
End	Single press the Play/Pause button.
Reject	Press and hold the Play/Pause button for 2s during an incoming call.

7. Indicator Lights

Charging	Red light.
Charging Complete	Red light turns off.
Standby Mode	Red and blue lights flash alternately.

Safety Warning

Please read all instructions and warning before using this product. Non-standard use will damage the product or personal safety.

- The battery is included in the product. Please do not expose it to the sunlight, fire or other over-heating environment; Do not store it in high temperature, strong light or magnetic field environment; Do not place it in other harsh environments such as fire source. If water enters, please dry it naturally before use.
- Improper use can damage the product or may endanger personal and property safety.
- Our company will not bear any legal liability for any personal or property damage caused by users who misuse the product, disregard the warning, or violate the terms and conditions of the User Manual.
- Non-professional personnel cannot disassemble this product.

Part Description	Toxic or Hazardous Substances and Elements					
	Lead (Pb)	Mercury (Hg)	Cadmium (Cd)	Hexavalent chromium (Cr(VI))	Polybrominated Biphenyls (PBB)	Polybrominated Diphenyl Ethers (PBDE)
PCB	X	O	O	O	O	O
CER	X	O	O	O	O	O
IC	X	O	O	O	O	O
Charging Cable	O	O	O	O	O	O
Shell	O	O	O	O	O	O

This form is compiled in accordance with SJJ/T 11354.
 O: Indicating that the content of the toxic and harmful substance in all homogeneous material of this part not exceed the limit specified in GB/T 26572 standard.
 X: Indicating that the content of the toxic and harmful substance in at least one homogeneous material of this part exceeds the limit specified in GB/T 26572 standard.

FCC Warning

This device complies with Part 15 of the FCC Rules. Operation is subject to the following two conditions:
 (1) This device may not cause harmful interference, and (2) this device must accept any interference received, including interference that may cause undesired operation.

NOTE 1: This equipment has been tested and found to comply with the limits for a Class B digital device, pursuant to part 15 of the FCC Rules. These limits are designed to provide reasonable protection against harmful interference in a residential installation. This equipment generates uses and can radiate radio frequency energy and, if not installed and used in accordance with the instructions, may cause harmful interference to radio communications. However, there is no guarantee that interference will not occur in a particular installation. If this equipment does cause harmful interference to radio or television reception, which can be determined by turning the equipment off and on, the user is encouraged to try to correct the interference by one or more of the following measures:
 - Reorient or relocate the receiving antenna.
 - Increase the separation between the equipment and receiver.
 - Connect the equipment into an outlet on a circuit different from that to which the receiver is connected.
 - Consult the dealer or an experienced radio/TV technician for help.

NOTE 2: Any changes or modifications to this unit not expressly approved by the party responsible for compliance could void the user's authority to operate the equipment.

NOTE 3: The device has been evaluated to meet general RF exposure requirement. The device can be used in portable exposure condition without restriction.

FCC ID: 2A7Z4-NBB

What's in the Box



Wireless On-Ear Headphones x1



3.5mm Audio Cable x1



USB-C Charging Cable x1



User Manual x1



Warranty Card x1

Note

Please read all instructions and warning before using this product. Non-standard use will damage the product or personal safety.

- The battery is included in the product. Please do not expose it to the sunlight, fire or other over-heating environment; Do not store it in high temperature, strong light or magnetic field environment; Do not place it in other harsh environments such as fire source. If water enters, please dry it naturally before use.
- Improper use can damage the product or may endanger personal and property safety.
- Our company will not bear any legal liability for any personal or property damage caused by users who misuse the product, disregard the warning, or violate the terms and conditions of the User Manual.
- Non-professional personnel cannot disassemble this product.
- Do not use appliances or loads that exceed the output current of this product.